

INSTALLATION AND OPERATION INSTRUCTIONS

MEGA 30

CENTRAL HEATING APPLIANCE.

The Mega Nectre 30 freestanding woodheater was shown to meet the exclusion requirements of AS 4013/NZS 7403 Section: 1.2.2(b).

HEAT OUTPUT EXCEEDS 25 kW.

Firstly check all local building and heating regulations. Different states and different localities have varying regulations about the installation and operation of woodstoves and you and your installer should be aware of these.

POSITIONING THE NECTRE - We include a diagram showing approved distances from the heater to combustible side and back walls. This also gives details of the floor protector size. These clearance distances can only be reduced if the surrounding walls or floor are made of non-combustible material eg. (stone, brick or concrete).

FLOOR PROTECTOR REQUIREMENTS - The heater requires a floor protector which consists of a 12mm thick sheet of fibre-cement with a thermal conductivity of .41W/m degree K. It must extend 200mm either side and 650mm in front of the firebox door opening.

CONSTRUCTION OF THE FLUE- A free standing stove should have a flue kit made of stainless steel or vitreous steel and shall extend not less than 4.6m from the top of the floor protector and meets the requirements of AS/NZS2918/2001 Section 4. The length will depend on ceiling height and roof design but the top of the flue pipe must be a minimum of 600mm above the ridge if the flue penetrates the roof within 3m of the ridge, or to be of sufficient height to be 3m horizontally from the roof line but a minimum height of 1m through the roof.

If the draft is insufficient or periodic downdrafting occurs and the stove smokes or only burns slowly, extending the flue or fitting a specialised cowl will usually cure it.

In the roof cavity and above the roof it is essential that the flue has a double outer casing (this is an active pipe-150mm stainless steel, 200mm and a 250mm outer casings) with a reasonable air space (at least 25mm) between all three pipes. This double cased flue is important to prevent condensation on the upper cooler parts of the flue as well as being a safety feature enabling you to get better clearances to combustibles in the ceiling space.

The flue kit required for the MEGA Nectre should also have a drop box exposed 150mm below from the ceiling with a full length decromesh, which is unperforated for 120 degrees of its circumference (perforation facing forward into the room) from the drop box to the heater. A 900mm long 120 degree stainless steel flue mounted shield is to be fitted between the inside surface of the first length of decromesh and the flue pipe.

If the stove is fitted into an existing chimney ensure that it is sealed at the base of the chimney with a register plate and continue flue pipe until it terminates outside the chimney in accordance with AS/NZS2918:2001 4.9.1

REFER TO DRAWING IN THESE INSTRUCTIONS ON FLUE INSTALLATION (Page.4)

WARNING: THE APPLIANCE AND FLUE-SYSTEM SHALL BE INSTALLED IN ACCORDANCE WITH AS/NZS 2918 AND THE APPROPRIATE REQUIREMENTS OF THE RELEVANT BUILDING CODE OR CODES.

CAUTION: MIXING OF THE APPLIANCE OR FLUE-SYSTEM COMPONENTS FROM DIFFERENT SOURCES OR MODIFYING THE DIMENSIONAL SPECIFICATION OF COMPONENTS MAY RESULT IN HAZARDOUS CONDITIONS. WHERE SUCH ACTION IS CONSIDERED, THE MANUFACTURER SHOULD BE CONSULTED IN THE FIRST INSTANCE.

CAUTION: CRACKED AND BROKEN COMPONENTS e.g. GLASS PANELS OR CERAMIC TILES, MAY RENDER THE INSTALLATION UNSAFE.

WHERE A WATER JACKET IS FITTED

WARNING: DO NOT CONNECT TO AN UNVENTED HOT WATER SYSTEM.

INSTALL IN ACCORDANCE WITH AS 3500.4.1. OR NZS 4603 AND THE APPROPRIATE REQUIREMENTS OF THE RELEVANT BUILDING CODE OR CODES.

ASSEMBLING THE NECTRE - Remove the bricks from inside the heater, slide the heat shield with smoke shelf hooks on it inside the firebox, top/front. (Slide points each side inside top of firebox) then lift the steel smoke shelf and locate it at the top of the firebox on the location lugs. Firstly lay a bed of bricks flat on the floor of the firebox then a row standing on end around the sides and back of the heater. Refer to drawing on fire brick layout in these instructions. Sit the brick retainer down onto the standing bricks to hold in place. There may be some gaps left between the bricks, but this is not a problem, because gaps will fill up with ash as you use the heater.

There are also two triangular bricks supplied which sit on top of the bottom bricks and are pushed up against the front face of the heater.

LIGHTING THE NECTRE- Now that the stove is correctly installed, it is ready for its first lighting.

The Nectre MEGA 30 feature a dual air control system. Air is introduced into the fire at the top of the firebox as well as the bottom. The top air is operated by the sliding control located on the top left hand corner of the unit. The bottom air control is located on the door of the heater. The bottom air control is used for starting the fire or boosting it whilst the stove is being supervised.

1. Place a few pieces of dry kindling onto some screwed up newspaper and ignite.
2. As soon as it has caught add some larger pieces of wood. Load the wood into the firebox so that the logs are placed at right angles to the door opening. Close the door and open the bottom air control located on the door. Make sure that the top air control is closed.
3. When the fire has a well established coal base add full size logs. Keep the bottom air open until the logs have caught then shut it and open the top air fully. Adjust the operating temperature of your fire by opening or closing the top air control. The normal or medium operating position is with the top air at about half way.

CAUTION: DO NOT LEAVE THE STOVE UNATTENDED WITH THE BOTTOM AIR CONTROL OPEN AS OVER FIRING MAY OCCUR, OR WITH CERTAIN TYPES OF WOOD, SPITTING THROUGH THE OPENINGS IS POSSIBLE.

The first few times that the stove is lit the stove paint will give off smoky fumes as it cures. Don't panic, once the paint has cured this will not reoccur. Keep the room well ventilated eg. (open doors and windows) until these fumes have cleared.

SLOW BURNING (e.g. overnight) - To make the heater burn for a long period, fill with large pieces of dry hardwood. Open the top air control fully and burn briskly for a few minutes to get the logs alight and then fully close the top air control. After burning overnight, the fire may be revived rapidly by placing small pieces of wood on the hot ashes and coals and opening the bottom air control fully to boost the fire. Close the bottom air off once the fire is established and control the fire by adjusting the top air control.

RAPID BURNING - To obtain maximum heat from your NECTRE MEGA 30, firstly establish the fire and then leave it running with the top air control open fully and bottom air closed. Keep an eye on your stove when you do this as with a good flue draft and dry wood, it is possible for the stove to glow red hot. Burning the fire with the top air control fully open will often not give the hottest fire as much of the heat is lost up the flue and so does not come into the room. Similarly running the stove with the door open will not produce maximum heating in the room as the stove will draw a lot of warmed air out of the room.

MAINTENANCE

1. Removing the Ashes - Depending on the type of wood burned, the ashes will need removing every 2 to 6 weeks. With a small shovel, push the hot coals to one side and shovel most of the ash into a metal bucket. The fire burns the ashes extremely finely so cover the bucket and take care not to stir up the ashes too much.

2. Cleaning Paint Work & Glass - The stove, when cool, can be cleaned with a damp cloth. Over the years the black will fade and should be touched up with a high temperature stove paint. Nectres are painted with Stovebright Metallic Black, which should be available from your nearest Nectre dealer. We do not recommend graphite based stove polish. To clean the glass we recommend wiping with water or a household cleaner such as Ajax "Spray & Wipe" and with steel wool. Do not use abrasive cleaners or hard pot scourers.

3. Door Seals - The door seal is a 10mm. Round braided fibreglass rope. If it should need replacing, fix it in its groove with silicone mastic.

4. Fire Bricks - The bricks should last many years, but if any need replacing they can be placed into position and are held in place at the top by the angle brick retainer.

5. Chimney Clean - The frequency with which the chimney will need cleaning will depend on the way that the stove has been used as well as the type and dryness of the wood burned. Keep an eye on the flue passages and if there appears to be a build up of soot it is time to clean the flue. To get at the flue from inside the stove, remove the smoke shelf from under the flue.

REPLACEABLE COMPONENTS OF THE APPLIANCE

1. Firebricks (21) x234x118x40 + 4 Short Bricks,
+ 2 triangular front bricks.
2. Baffle Plate : Steel 500 x 300 x 12mm
3. Baffle Plate Retainer : Steel.
4. Glass Seal: 1360 x 8mm x 3mm.
5. Door Rope : 1580 x 13mm round.
6. Glass : 476 x 200 x 5mm Pyro ceramic.
7. Brick Retainer : 655mm x 445mm.

NECTRE MEGA 30. FIRE BRICK LAYOUT

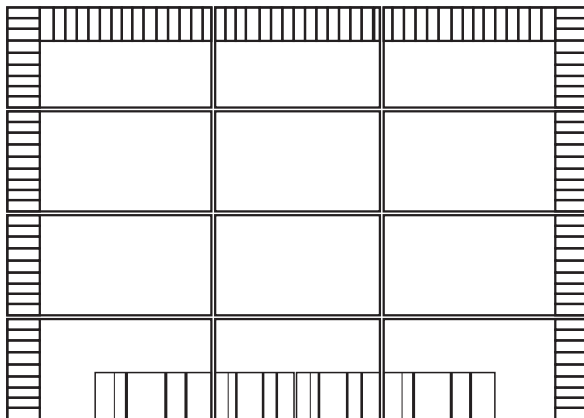

Your MEGA NECTRE fire brick packs contain
21 Full size fire bricks.
4 Short standard fire bricks.
plus **2 triangular fire bricks.**



Firstly place 8 full size and 4 short standard bricks laying flat on the firebox bottom as per drawing.



Then place 4 full size bricks on end each side and 5 across the back as per the drawing.



There are also 2 triangular bricks supplied that must be placed along front edge inside the door opening side by side.

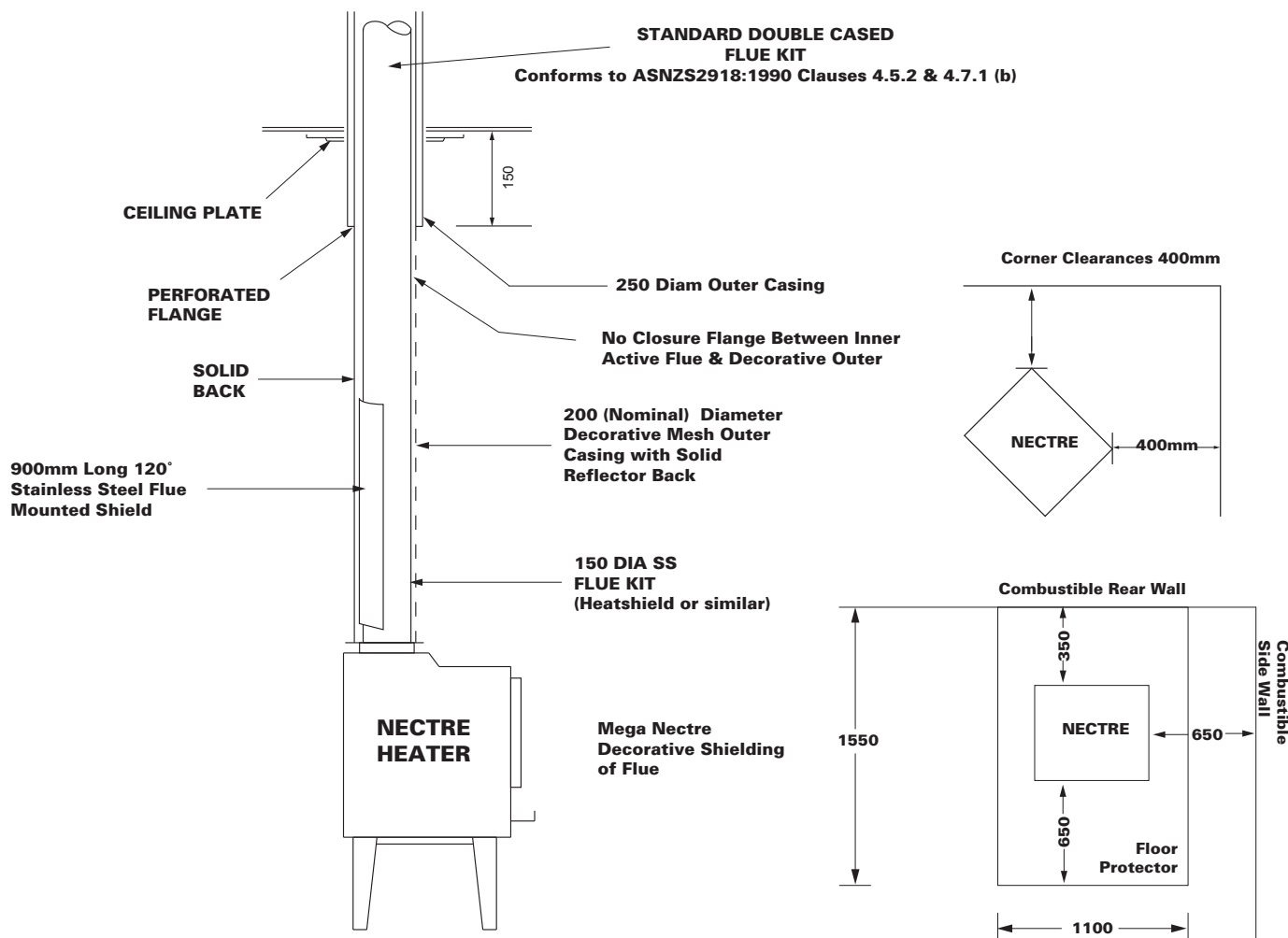

WARNING: DO NOT USE FLAMMABLE LIQUIDS OR AEROSOLS TO START OR REKINDLE THE FIRE.

WARNING: DO NOT USE FLAMMABLE LIQUIDS OR AEROSOLS IN THE VICINITY OF THIS APPLIANCE WHEN IT IS OPERATING.

WARNING: DO NOT STORE FUEL WITHIN HEATER INSTALLATION CLEARANCES.

WARNING: WHEN OPERATING THIS APPLIANCE AS AN OPEN FIRE USE A FIRESCREEN.

WARNING: OPEN AIR CONTROL (AND DAMPER WHEN FITTED) BEFORE OPENING FIRING DOOR.

CAUTION: THIS APPLIANCE SHOULD NOT BE OPERATED WITH A CRACKED GLASS.

CAUTION: THIS APPLIANCE SHOULD BE MAINTAINED AND OPERATED AT ALL TIMES IN ACCORDANCE WITH THESE INSTRUCTIONS.

CAUTION: THE USE OF SOME TYPES OF PRESERVATIVE TREATED WOOD AS A FUEL CAN BE HAZARDOUS.

Recommended Fuel:- Any dry hardwood that has been seasoned for at least 12 months. All fuel should be stored with protection from the weather to minimise moisture content.

KEEP THESE INSTRUCTIONS FOR FUTURE REFERENCE