

D1000 EPI FIRE BOX



Chazelles

D1000 EPI FIRE BOX



Features and Benefits :

- 10 Years Warranty
- 100% French made
- Dual opening door mechanism :
- Both doors Lateral (sides) and 3 doors lift up together .
- Double skin structure
- Lined with 70mm firebricks - 370 kgs
- 3 Ceramic glass 820°C heat resistant
- Estimated max heat output approx. 350 sq meters *
- Average smoke temperature 232°C
- Energy efficiency : 70.5%**
- 4.2 star rating
- Flue size 250 mm or 10"
- De ashing with ash extractor supplied
- EPA approved and Australian standards AS/NZS 4013
- Hot air ducting system 3 rooms (up to 5 rooms) .

* Varies depend upon ceiling height , installation and location of construction

** Ratios according European standard tests : EN13229/2001

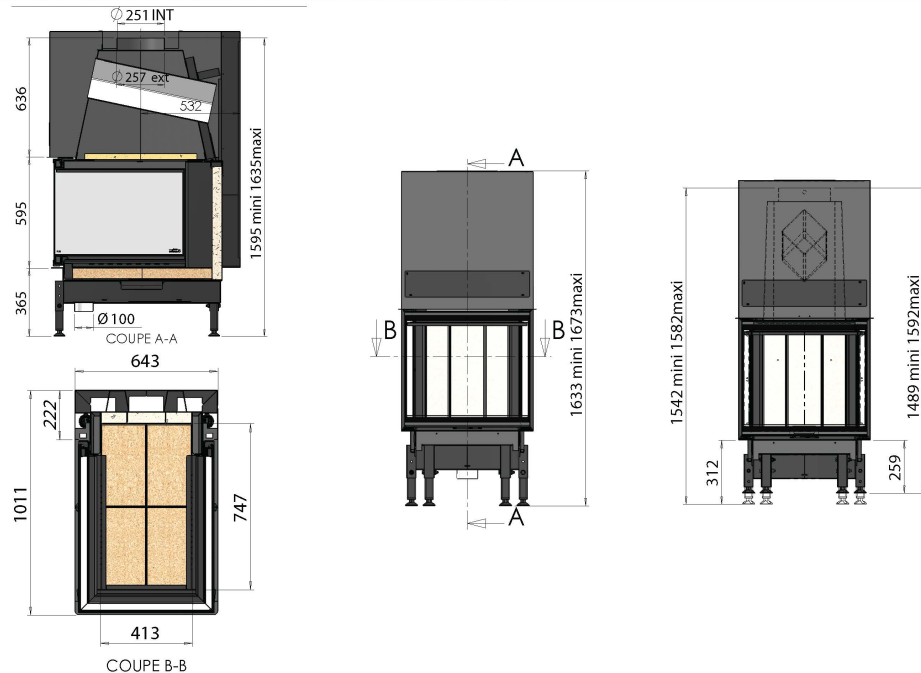

This stunning triple sided unit can be placed in the center of a room or positioned to one side to create a fabulous room divider. No matter where you are in the room the D1000 EPI Chazelles fireplace offers magnificent view of the fire. The 3 large retractable doors sliding up out of view at the same time is unique and unequalled system proposed by Chazelles in Australia . The D1000 EPI can be encompassed in any surround design you desire , its clean and uninterrupted line is enhanced by the use of a clever removable handle . A hot air ducted system allows you to infuse warmth into every corner of every room and a beautifully conceived ash extractor makes cleaning a matter of consummate ease . With the D1000 EPI you need only to imagine possibilities

NSW Head Office & Showroom, 396 Princes Highway, St Peters NSW 2044. Tel: 61-2 9550 6290.

QLD Shop 4/125 Sugar Road, Maroochydore QLD 4558. Tel: 61-7 5443 7275.

QLD Shop 1A/1 Gateway Drive, Noosaville QLD 4556. Tel: 61-7 5473 0023.

QLD Shop 6A/566 Kawana Way, Birtinya QLD 4575. Tel: 61-7 5493 3744.

ACT 80-82 Wollongong Street, Fyshwick ACT 2609. Tel: 61-2 6280 7565.

WA Unit 3, 42-44 Farrall Road, Midvale WA 6056. Tel: 61-8 9250 1322.

VIC 4 Green Street, Thomastown VIC 3074. Tel: 61-3 9465 4433.

TAS 266 Argyle Street, HOBART TAS 7000. Tel: 61-3 6234 1919.

SA 40 Maple Ave, Forestville SA 5035. Tel: 61-8 8371 1222.

Chazelles

WWW.CHAZELLES.COM.AU